

# K50

## OPTIONAL

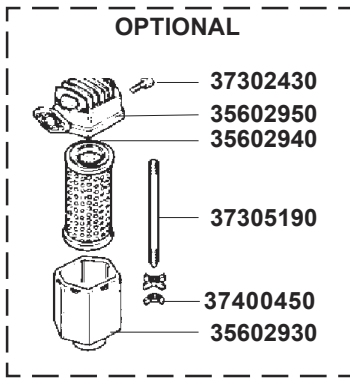

- 37302430
- 35602950
- 35602940
- 37305190
- 37400450
- 35602930

## Optional



- 14400830

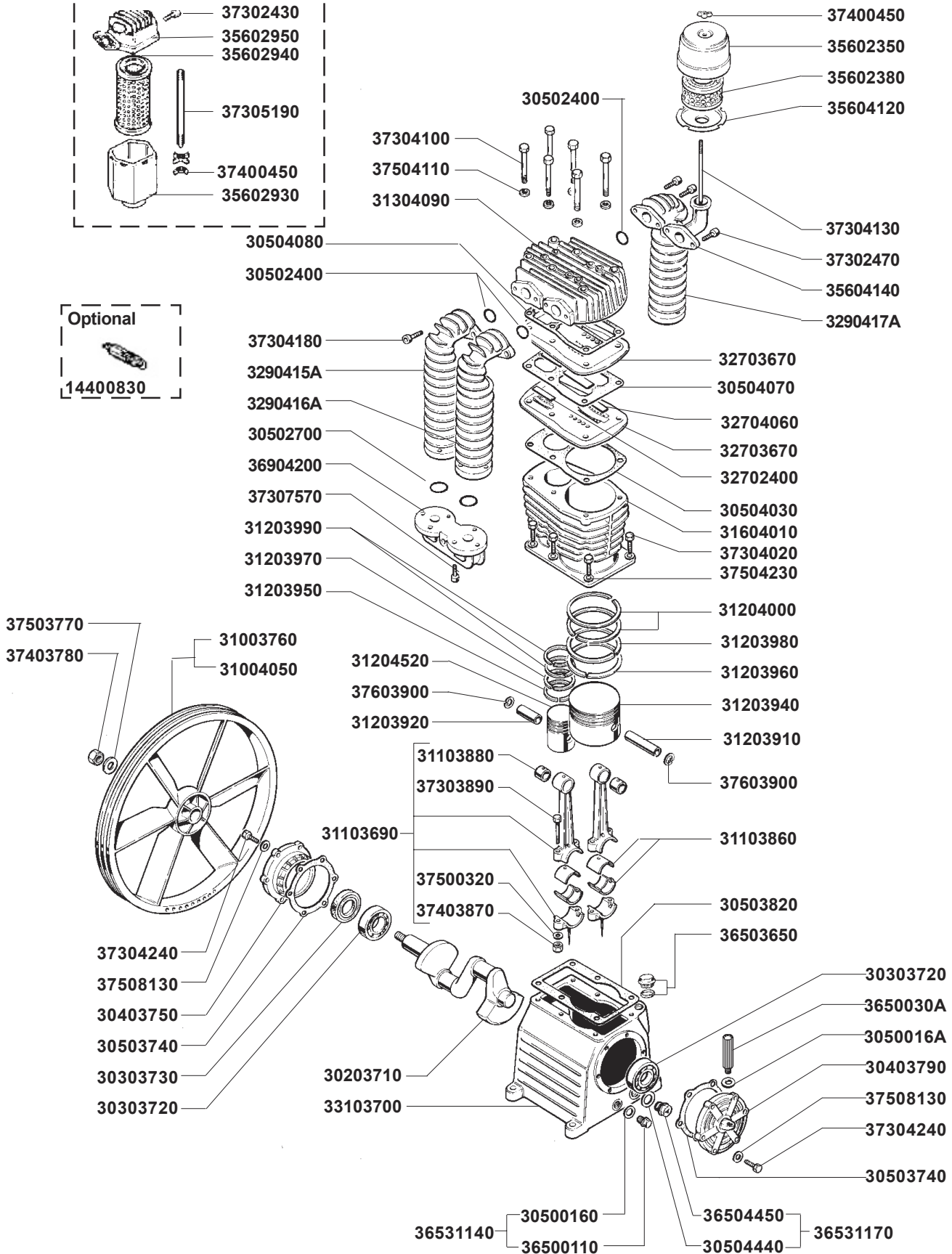

- 37400450
- 35602350
- 35602380
- 35604120
- 30502400
- 37304100
- 37504110
- 31304090
- 37400450
- 35602930
- 37304130
- 37302470
- 35604140
- 3290417A
- 30504080
- 30502400
- 37304180
- 3290415A
- 3290416A
- 30502700
- 36904200
- 37307570
- 31203990
- 31203970
- 31203950
- 32703670
- 30504070
- 32704060
- 32703670
- 32702400
- 30504030
- 31604010
- 37304020
- 37504230
- 31204000
- 31203980
- 31203960
- 31203940
- 31203910
- 31204520
- 37603900
- 31203920
- 31103880
- 37303890
- 37603900
- 31103860
- 31103690
- 37500320
- 37403870
- 30503820
- 36503650
- 37503770
- 37403780
- 31003760
- 31004050
- 37304240
- 37508130
- 30403750
- 30503740
- 30303730
- 30303720
- 30203710
- 33103700
- 30303720
- 3650030A
- 3050016A
- 30403790
- 37508130
- 37304240
- 30503740
- 36531140
- 30500160
- 36500110
- 36504450
- 30504440
- 36531170

CODE	DENOMINAZIONE	DENOMINATION	DENOMINATION	BEZEICHNUNG	DENOMINACION
30203710	Albero a gomito	Grankshaft	Vilebrequin	Kurbelwelle	Arbol a codo
30303720	Cuscinetto	Ball bearing	Roulement à billes	Kugellager	Cojinete
30303730	Corteco	Bi-angular bearing	Joint	Dichtungsring	Guarnición
30403750	Supporto	Support	Support	Lagerflansch	Apoyo
30403790	Supporto	Support	Support	Lager	Apoyo
30500160	Guarnizione	Gasket	Joint	Dichtung	Empaquetadura
3050016A	Guarnizione	Gasket	Joint	Dichtung	Empaquetadura
30502400	O-Ring	OR	OR	OR	OR
30502700	O-Ring	OR	OR	OR	OR
30503740	Guarnizione	Gasket	Joint	Dichtung	Empaquetadura
30503820	Guarnizione	Gasket	Joint	Dichtung	Empaquetadura
30504030	Guarnizione	Gasket	Joint	Dichtung	Empaquetadura
30504070	Guarnizione	Gasket	Joint	Dichtung	Empaquetadura
30504080	Guarnizione	Gasket	Joint	Dichtung	Empaquetadura
30504440	Guarnizione	Gasket	Joint	Dichtung	Empaquetadura
31003760	Volano ø550	Flywheel ø550	Poulie ø550	Schwungrad ø550	Volante ø550
31103690	Biella completa	Complete connecting rod	Bielle complète	PLEuelstange komplet	Biela completa
31103860	Guscio	Bearing shell	Coussin pied de bielle	fLagerschale	Colchón
31103880	Boccola	Bush	Douille	Buchse	Bullon
31204000	Anello compressione BP	Compression ring BP	Anneau compression BP	Kolbenring BP	Anillo de compresión
31203910	Spinotto BP	Piston pin BP	Axe du piston BP	Bolzen BP	Bullon
31203920	Spinotto AP	Piston pin AP	Axe du piston AP	Bolzen AP	Bullon
31203940	Pistone BP ø120	Piston BP ø120	Piston BP ø120	Kolben BP ø120	Piston ø120
31203950	Raschia olio a feritoia AP	Slotted oil scraper AP	Segment raclleur AP	Ölanstreifring AP	Segmento colector AP
31203960	Raschia olio a feritoia BP	Slotted oil scraper BP	Segment raclleur BP	Ölanstreifring BP	Segmento colector BP
31203970	Raschia olio a scalino AP	Stepped oil scraper AP	Segment huileur AP	Ölabstreifring AP	Segmento aceite AP
31203980	Raschia olio a scalino BP	Stepped oil scraper BP	Segment huileur BP	Ölabstreifring BP	Segmento aceite BP
31203990	Anello compressione AP	Compression ring AP	Anneau compression AP	Kolbenring AP	Anillo de compresión AP
31204520	Pistone AP ø60	Piston AP ø60	Piston AP ø60	Kolben AP ø60	Piston AP ø60
31304090	Testata	Cylinder head	Culasse	Zylinderkopf	Cabeza
31604010	Cilindro	Cylinder	Cylindre	Zylinder	Cilindr
32702400	Valvola AP	VAlve AP	Clapet AP	Ventil AP	Valvula AP
32703670	Piastra valvole	Valves plate	Plaque clapets	Ventilplatte	Placa valvulas
32704060	Valvola BP	Valve BP	Clapet BP	Ventil BP	Valvula BP
3290415A	Collettore sinistro	Left cooler	Collecteur gauche	Linkes Sammelrohr	Colector izquierdo
3290416A	Collettore destro	Right cooler	Collecteur droite	Rechtes Sammelrohr	Colector derecho
3290417A	Collettore di scarico	Aftercooler	Collecteur d'échappement	Nachkühler	Colector de descarga
33103700	Monoblocco	Crankcase	Monobloc	Zylinderblock	Monobloque
35602350	Corpo filtro	Filter casing	Corps filtre	Filtergehäuse	Cuerpo filtro
35602380	Cartuccia filtro1	Filter cartridge	Cartouche filtre	Filtereinsatz	Cartucho filtro
35604120	Coperchio filtro	Filter cover	Couvercle filtre	Filter Deckel	Tapa filtro
35604140	Curva	Elbow	Coude	Kniestück	Curva
36500110	Tappo olio	Oil plug	Bouchon de vidage	Ölschraube	Tapón aceite
3650030A	Tappo olio	Oil plug	Bouchon de remplissage	Ölschraube	Tapón aceite
36503650	Tappo carico olio c/joint	Oil plug +joint	Bouchon de remplissage	Ölschraube +joint	Tapón aceite +joint
36504450	Livello olio	Oil sight gauge	Jauge d'huile	Ölstand	Nivel aceite
36531140	Tappo scarico olio c/joint	Oil plug discharge +joint	Bouchon de vidage +joint	Ölschraube +joint	Tapón aceite +joint
36531170	Livello olio c/joint	Oil level +/joint	Niv.d'huile +/joint	Ölstand +/joint	Visor de aceite +/joint
36904200	Raccordo 1-2	Connector 1-2	Collecteur 1-2	Anschlußstück 1-2	Empalmadura 1-2
37302470	Vite	Screw	Vis	Schraube	Tornillo
37302470	Vite	Screw	Vis	Schraube	Tornillo
37307570	Vite	Screw	Vis	Schraube	Tornillo
37303890	Vite	Screw	Vis	Schraube	Tornillo
37304020	Vite	Screw	Vis	Schraube	Tornillo
37304100	Vite	Screw	Vis	Schraube	Tornillo
37304130	Tirante	Tension rod	Tirant	Spannstange	Tirante
37304180	Vite	Screw	Vis	Schraube	Tornillo
37304240	Vite	Screw	Vis	Schraube	Tornillo
37403780	Dado	Nut	Ecrou	Mutter	Dado
37403870	Dado	Nut	Ecrou	Mutter	Dado
37500320	Rondella	Washer	Rondelle	Beilegscheibe	Arandela
37508130	Rondella	Washer	Rondelle	Beilegscheibe	Arandela
37503770	Rondella	Washer	Rondelle	Beilegscheibe	Arandela
37504110	Rondella	Washer	Rondelle	Beilegscheibe	Arandela
37504230	Rondella	Washer	Rondelle	Beilegscheibe	Arandela
37603900	Seeger	Circlip	Seeger	Seegerring	Seeger
<b>OPTIONAL VOLANC</b>					
31004050	Volano ø450	Flywheel ø450	Poulie ø450	Schwungrad ø450	Volante ø450
<b>OPTIONAL FILTRO EXA</b>					
35602930	Coperchio filtro	Filter cover	Couvercle filtre	Filter Deckel	Tapa filtro
35602940	Cartuccia filtro	Filter cartridge	Cartouche filtre	Filtereinsatz	Cartucho filtro
35602950	Corpo filtro	Filter casing	Corps filtre	Filtergehäuse	Cuerpo filtro
37302430	Vite	Screw	Vis	Schraube	Tornillo
37305190	Tirante	Tension rod	Tirant	Spannstange	Tirante
37400450	Dado	Nut	Ecrou	Mutter	Dado
37402980	Dado	Nut	Ecrou	Mutter	Dado
<b>ALTRI OPTIONAL</b>					
14400830	Valvola di sicurezza	Safety valve	Clapet de sureté	Sicherventil	Valvula de seguridad